

# Proposed Ground & First Floor Plan

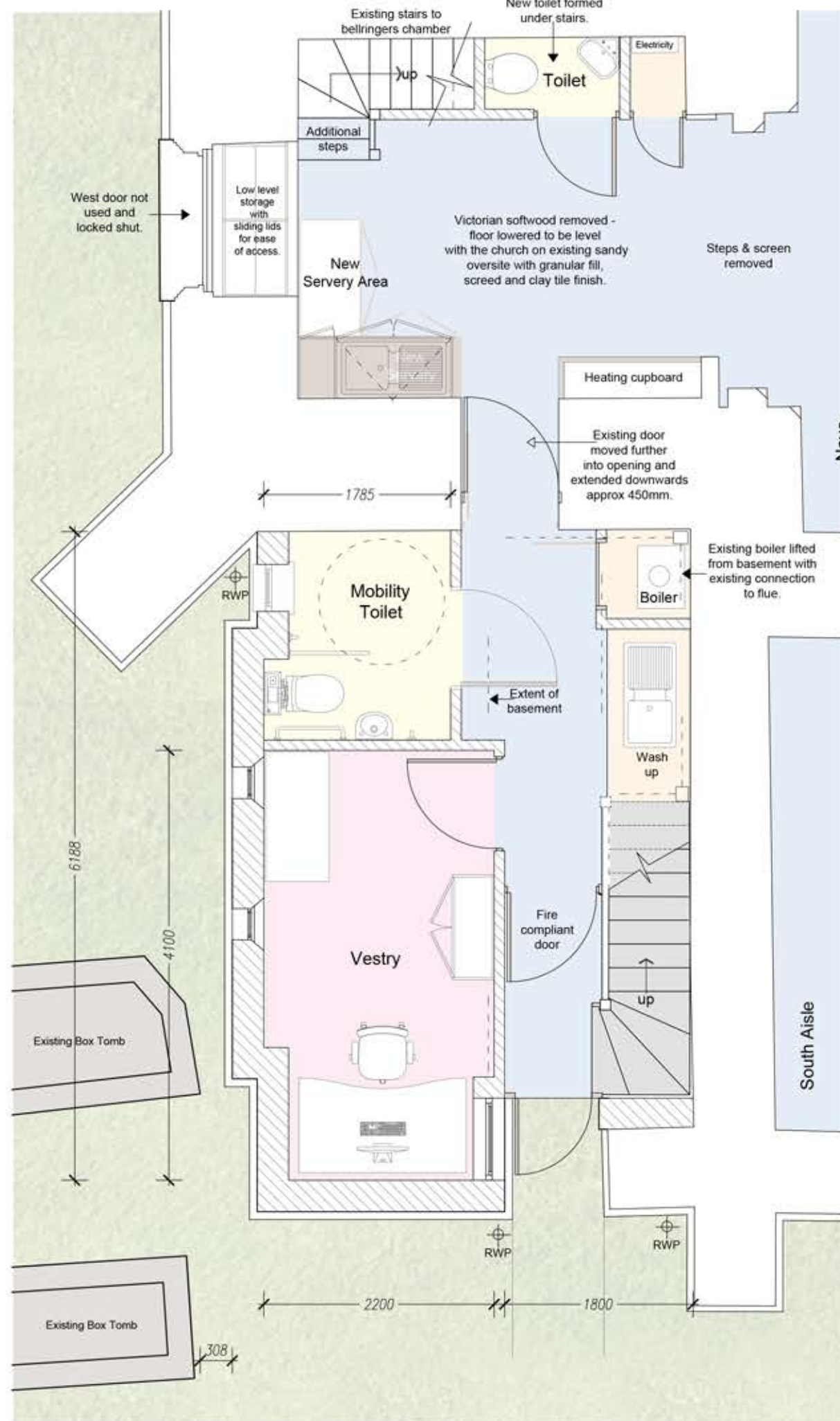
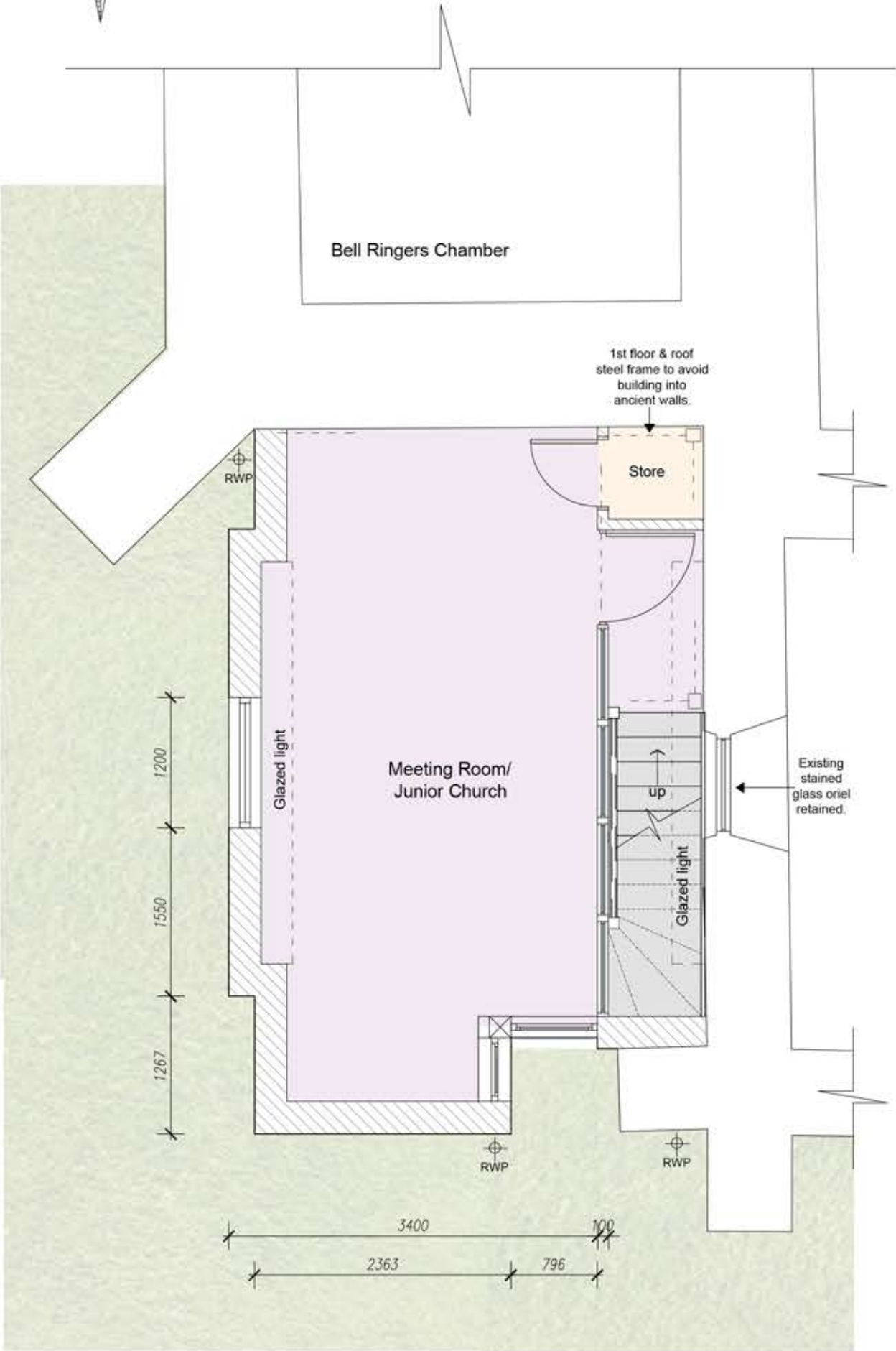

Existing plans, elevations and sections and levels are extracted from detailed survey drg nos RGL-14-1899-01 to 05, carried out by RGL Surveys Ltd.

Check all dimensions prior to setting out.

### Revisions

Rev	Date	Description
Rev A	April 15	Additional toilet & servery in tower. KMH.
Rev B	April 15	Toilet moved under stair, screen and steps removed. KMH.
Rev C	May 15	Additional information added. KMH.
Rev D	July 15	Moving of doors & servery area, from DAC site visit - 06Jul15. KMH.
Rev E	Nov 15	Additional window added. DJB.
Rev F	Jan 16	Lower window removed and replaced with 2 no lancet windows. JKD

**Robin Nugent Architects**  
Chartered Architects ©  
Castle Barn Sedgwick Horsham  
West Sussex RH13 6QJ

T: 01403 734858 F: 01403 738368  
E: robin@robinnugentarchitects.co.uk  
W: www.robinnugentarchitects.co.uk

**Client:**  
The PCC of St Margaret's West  
Hoathly, Sussex

**Project:**  
Internal alterations & new facilities

**Drawing Title:**  
Proposed Ground & First Floor Plans  
of extension.

Scale: 1:50 Date: Mar 15 Drawn by: KMH

Drawing No: 14529/502 Revision: E

< Original size 60mm - A3 at full size >